



5.5KWh-26.4KWh High Voltage Stack Battery

Up to 6 towers in parallel (From 5.5 kWh to 153.6 kWh)

Enershare Battery CORE 1.0



Shenzhen Enershare Technology Co.,Ltd

Tel: 0086-755-28748610 E-mail: wesleyyan@enershare.cn

<https://www.enershare.cn>

The Enershare Battery CORE 1.0 Series 2 Models for all Scenario

Enershare Battery CORE 1.0 Series, Sparkling With Innovation, Provides You With Intelligent Integration Storage Solutions. There Are 2 Models Under High Voltage Platform, Which Are Enershare Power-CORE 1.0 and Enershare Energy-CORE 1.0 Both Of Them Can Handle Up To A Voltage Of 600 V Sharing Our Minted Smart BMS .

Enershare Battery CORE 1.0 Series Will Inaugurate a New Era In The Residential Energy Storage Industry.

Enershare Power-CORE 1.0

System Energy: 5.52~13.80 kWh
Nominal Voltage: 204V ~ 512V
Stacks: 2-5 Battery

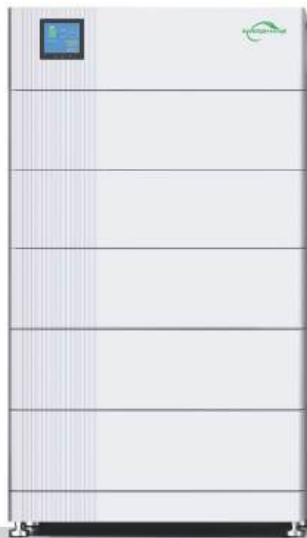

Enershare Energy-CORE 1.0

System Energy: 9.9~26.4 kWh
Nominal Voltage: 192V~ 512V
Stacks: 3-8 Battery



Smart System Design

- LFP Chemistry
- Automatic Inverter Configuration (set-up free)
- Automatic Battery System Configuration (set-up free)
- Intelligent Display (Key Info, Err code, SOC)
- Power and Energy for all applications
- 1 and 3 phase, on / off grid / back up support
- No DC/DC, high efficiency system layout
- Up to 6 towers in parallel



Smart Installation Design

- Stackable Design, Easy Installation, ≤ 36.5kg / Stack
- Slim and Compact
- Plug-Play (Direct Connect RJ45)
- VDE2510 Compliances
- Aluminum Housing
- IP65 Protection

Enershare Power-CORE 1.0 is a Power Type With a Capacity Of 2.76 KWh, 102.4 V In Each Battery Stack.

Enershare Energy-CORE 1.0 is an energy type with a capacity of 3.2 kWh, 64 V in Each Battery Stack.



Models	Power-CORE 1.0	Energy-CORE 1.0
Smart BMS 1.0		
Operating Voltage Range	120-600V	120-600V
Max Output Current	30 A	30 A
Peak Output Current	50 A (5s)	50 A (5s)
Communication	CAN 2.0/ RS485	CAN 2.0/ RS485
Stacks Scalability	2 To 5 Stacks	3 To 8 Stacks
Dimensions (H/W/D)	175* 650* 260 mm	175* 650* 260 mm
Weight	≤ 20 kg	≤ 20 kg



Battery Stack	Power-CORE 1.0	Energy-CORE 1.0
Usable Energy	2.76 kWh	3.3 kWh
Battery Cell Technology	LFP	LFP
Operation Temperature	-10~55 °C	-10~55 °C
Nominal Voltage	102.4 V	64 V
Operating Voltage Range	86.4~116.8 V	54~73 V
Max Output Current	25 A	30 A
Peak Output Current	50 A (5s)	50 A (5s)
Dimensions (H/W/D)	175* 650* 260 mm	175* 650* 260 mm
Weight	≤ 35 kg	≤ 36.5 kg

Stackable

Up to 2-8 battery 5.5KWh-26.4KWh

Increase the capacity freely in lifetime It grows as your family grows

Stackable battery units with direct connection

No additional Wires, No additional Screws

1 Person Work

Time saving, Cost Saving



High Scalability, Able To Be Paralleled Up To 6 Towers

Wide capacity options from 5.5kWh to 153.6kWh



Enershare Power-CORE 1.0

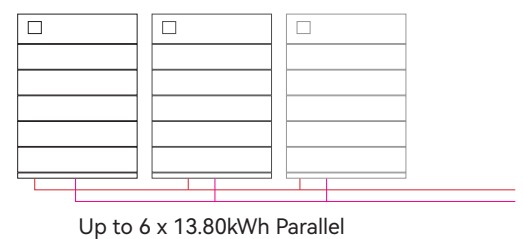
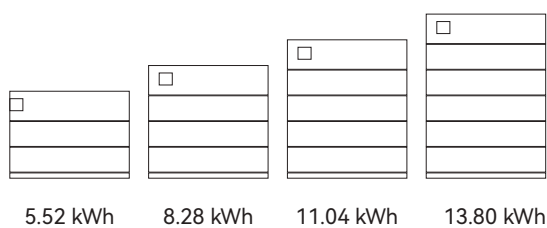

Enershare Energy-CORE 1.0

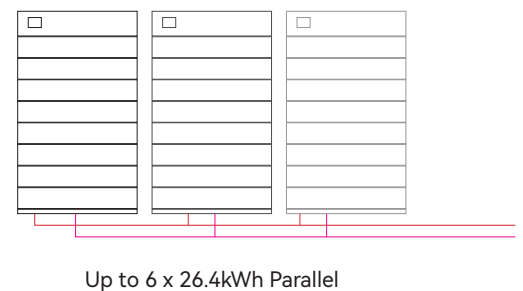
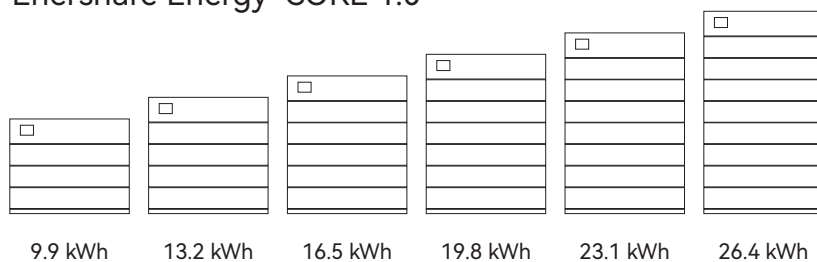

Enershare Power-CORE 1.0

5.5KWh-13.8KWh High Voltage Stack Battery

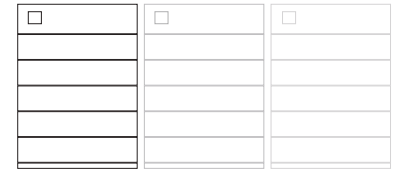

Technical Specification

6 x 13.80kWh **Parallel**

Number of Stacks	2	3	4	5
Usable Energy	5.52 kWh	8.28 kWh	11.04 kWh	13.80 kWh
Max Output Current	25 A			
Peak Output Current	50 A (5s)			
Nominal Voltage	204.8 V	307.2 V	409.6 V	512 V
Operating Voltage Range	172.8~233.6 V	259.2~350.4 V	345.6~467.2 V	432~584 V
Scalability	Up to 6 towers (From 5.36 kWh to 80.4 kWh)			
Dimensions (H*W*D) (mm)	625* 650* 260mm	800* 650* 260mm	975* 650* 260mm	1150* 650* 260mm
Weight	90 kg	125 kg	160 kg	195 kg
Operation Temperature	-10~55 °C			
Protection Rating	IP65			
Round-trip Efficiency	≥ 96 %			
Certification & Compliance	UKCA / IEC62619 / CEC / CE / UN38.3			
Applications	ON Grid / ON Grid Backup / OFF Grid			
Warranty	10 Years			

Enershare Energy-CORE 1.0

9.9KWh-26.4KWh

High Voltage Stack Battery

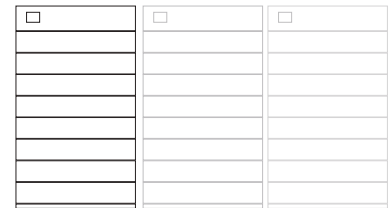

Technical Specification

6 x 26.4kWh **Parallel**

Number of Stacks	3	4	5	6	7	8
Usable Energy	9.9 kWh	13.2 kWh	16.5 kWh	19.8 kWh	23.1 kWh	26.4 kWh
Max Output Current	30 A					
Peak Output Current	50 A (5s)					
Nominal Voltage	192 V	256 V	320 V	384 V	448 V	512 V
Operating Voltage Range	162~219 V	216~292 V	270~365 V	324~438 V	378~511 V	432~584 V
Scalability	Up to 6 towers in parallel (From 9.6 kWh to 153.6 kWh)					
Dimensions (H*W*D) (mm)	800* 650*260 mm	975* 650*260 mm	1150* 650*260 mm	1325* 650*260 mm	1500* 650*260 mm	1675* 650*260 mm
Weight	129.5 kg	166 kg	202.5 kg	239 kg	275.5 kg	312 kg
Operation Temperature	-10~55 °C					
Protection Rating	IP65					
Round-trip Efficiency	≥ 96 %					
Certification & Compliance	UKCA / IEC62619 / CEC / CE / UN38.3					
Applications	ON Grid / ON Grid Backup / OFF Grid					
Warranty	10 Years					

User Case

Germany

Energy Core
tower setup with **Goodwe**

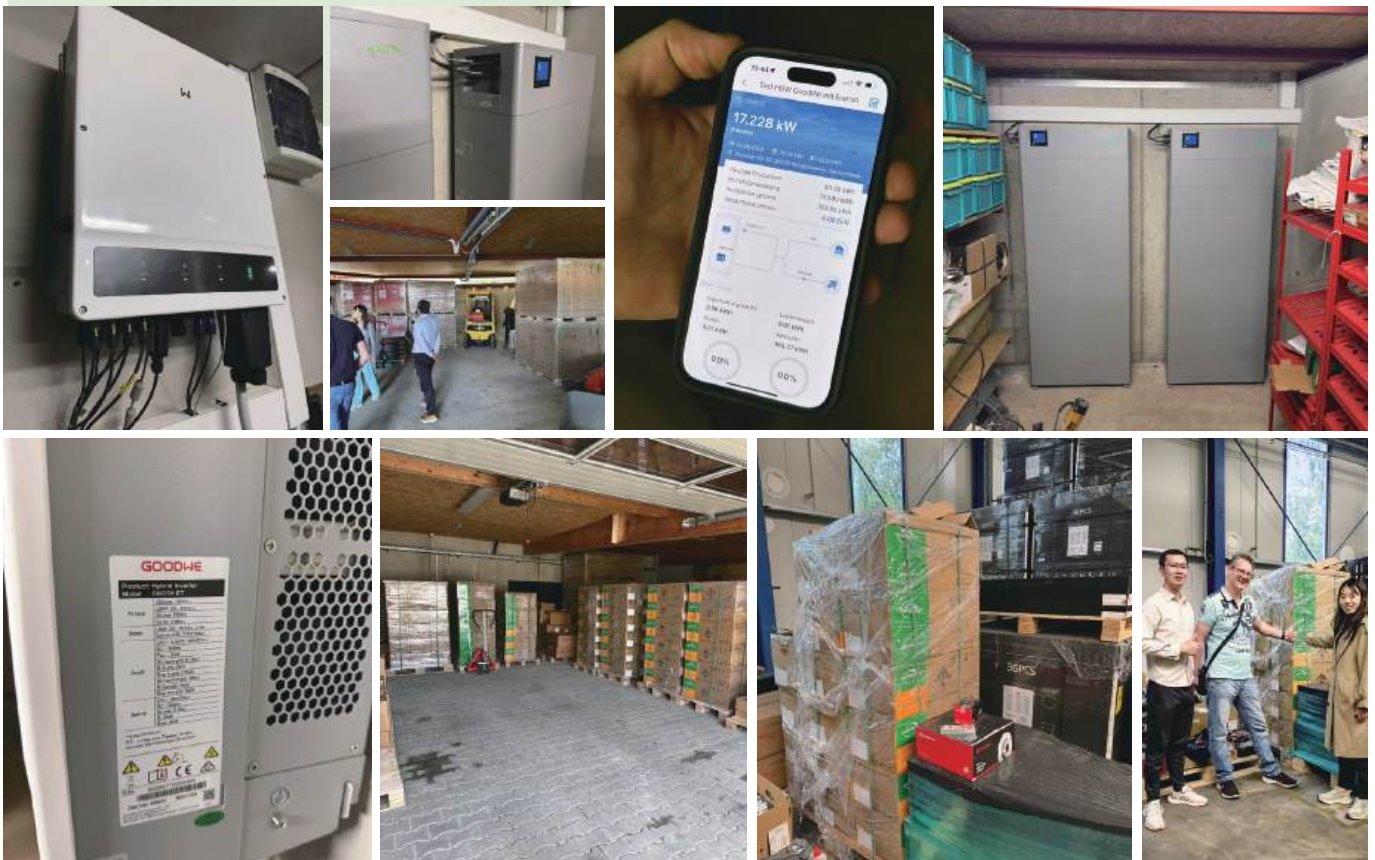

Austria

Energy Core 8 modules tower setup with **Sungrow** (SH10RT: three-phase 10kW)



Poland

Energy Core 3 modules tower setup with **Deye**



Hungary

Energy Core tower setup with **hoy miles**



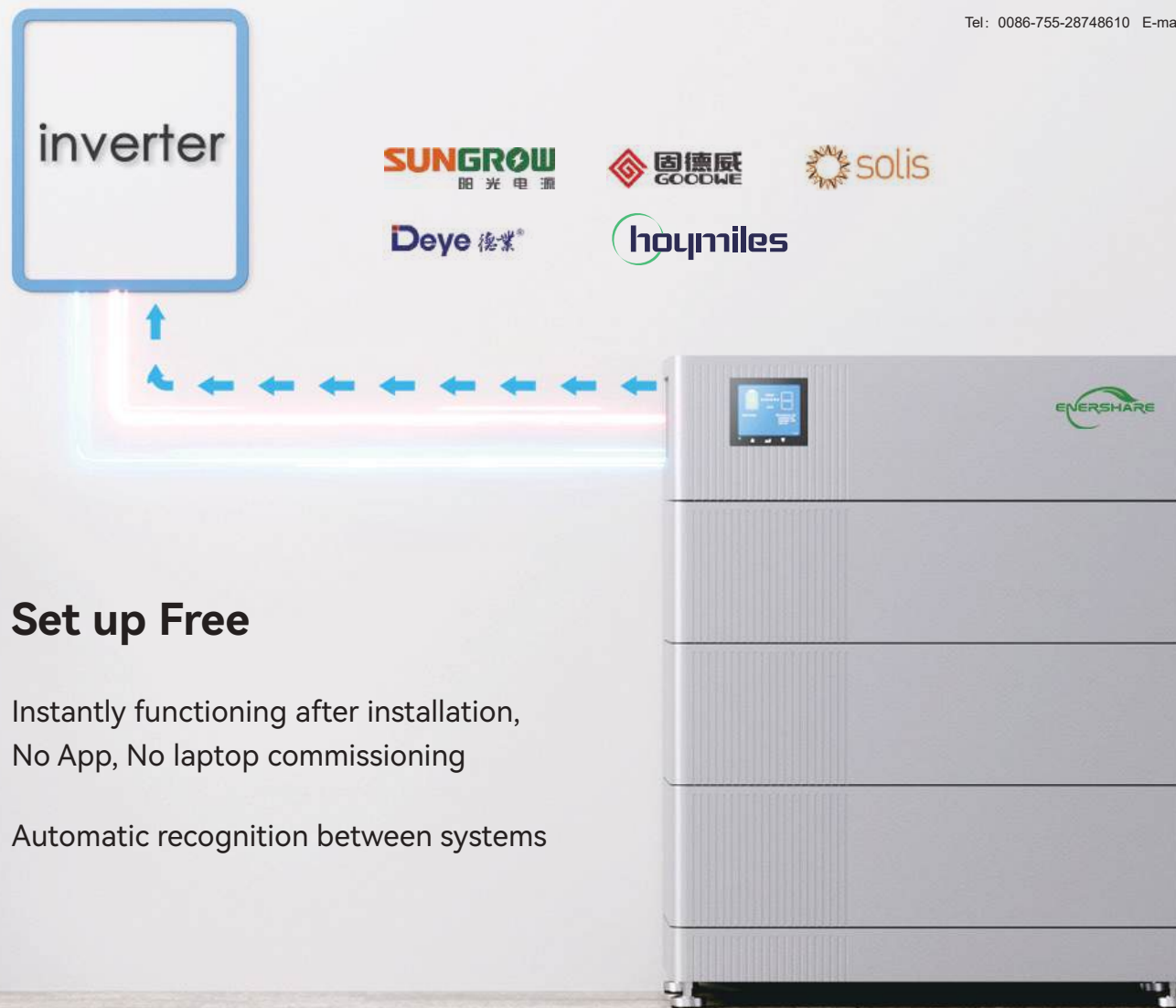

Set up Free

Instantly functioning after installation,
No App, No laptop commissioning

Automatic recognition between systems



Enershare Battery CORE 1.0 Series Battery Compatible Inverter List V1.5

Inverter		Stack Quantity		Minimum Firmware Version	
		Power-CORE 1.0	Energy-CORE 1.0	Inverter	Battery CORE 1.0 BMS
SunGrow	SH 3.0/3.6/4.0/5.0/6.0 RS	2-3	3-6	≥ ARM: SUNSTONE-H_01011.02.30 ≥ MDSP: SUNSTONE-H_03011.02.26	≥ V1.6-1.5
	SH 5.0/ 6.0/8.0/10 RT	2-5	3-8	≥ ARM: SAPPHIRE-H_01011.71.21 ≥ MDSP: SAPPHIRE-H_03011.71.19	
GoodWe	ET (5-10kW)	2-5	4-8	≥ ARM 13	≥ V1.6-1.5
	BT	2-5	4-8	≥ ARM 13	
	EH/BH	2-3	3-6	≥ ARM 07	
	EHB	2-4	3-6	≥ ARM 03	
	Notice: For the inverter which was manufactured before March 6th 2023, if meet the communication issue while installing, please contact the service of Goodwe for help.				
Solis	S6-EH3P(3-10)K-H	2-5	3-8	≥ V02	≥ V1.6-1.5
Deye	SUN-(5-20)K-SG01HP3-EU-AM2	2-5	3-8	≥ 2001-C01B	≥ V1.6-1.5
hoymiles	HYT-(5.0-12.0)HV-EUG1	2-5	3-8	≥ V01.00.06	≥ V1.8-1.5
	HAT-(5.0-10.0)HV-EUG1	2-5	3-8	≥ V01.00.06	

Note:

1. Maximum 6 Systems In Parallel Connection. For Parallel Connection, The Below Requirements Must Be Fulfilled:

a) Enershare Power-CORE 1.0 CANNOT Be Parallel Connected With Enershare Energy-CORE 1.0; b) Each Of The Parallel Connected System Must Have The Same Stack Quantity.